

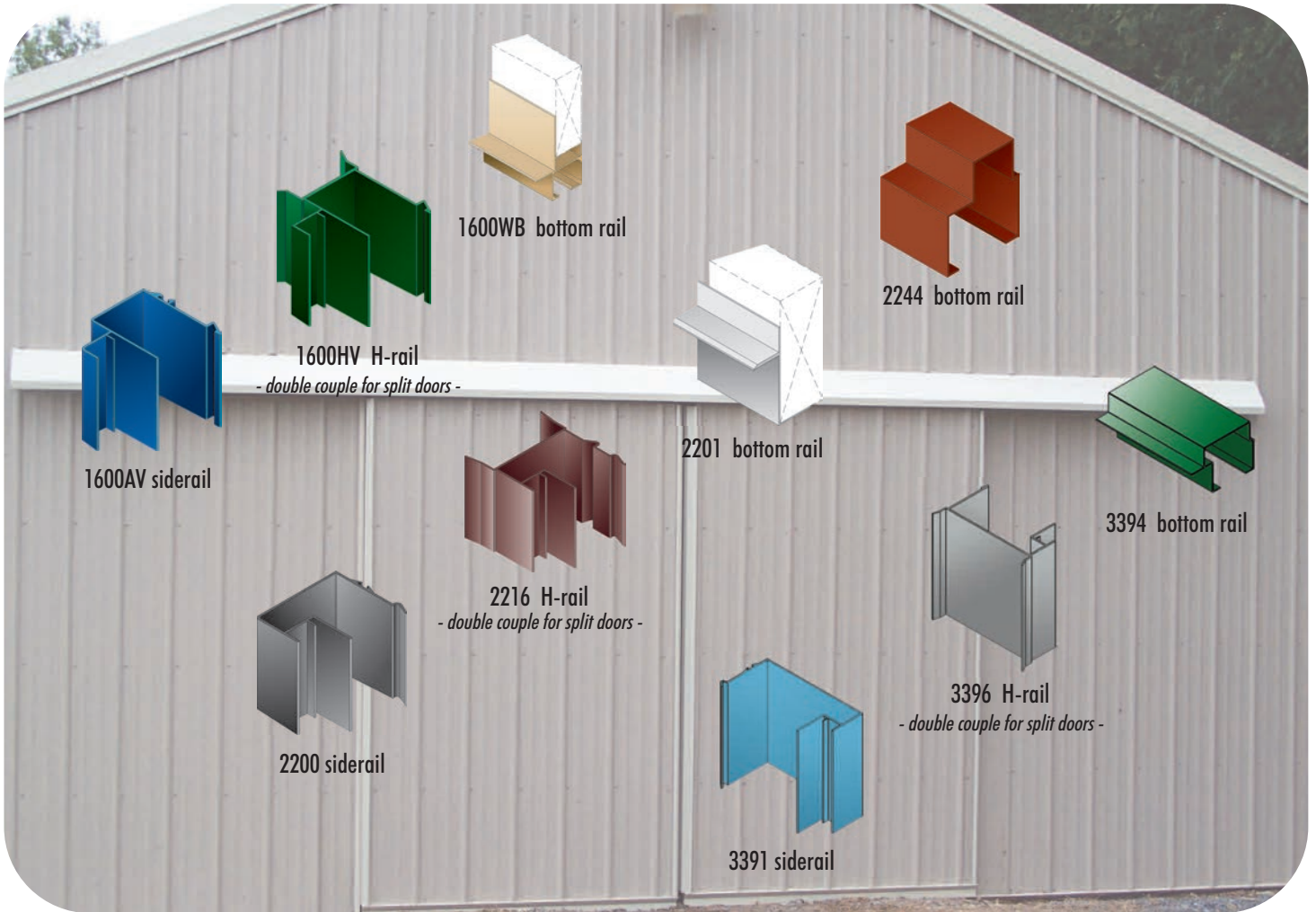

BUILT FOR POST FRAME

**THE INDUSTRY'S LEADING SUPPLIER
OF SLIDE FRAME COMPONENTS**

www.mwicomponents.com
Spencer, Iowa



**Two distinct 1 1/2" profiles • One 3 1/2" profile
For wood/metal and all metal framed slide doors**

• COLOR MATCHED •

Over 27 powder coat colors for exact match to most rollformers metal siding.

• JOB PACKED •

No minimum order to buy - job pack all of your color coordinated doors at one low price.
Or stock your most popular colors for even greater savings!

• AVAILABILITY •

Quick lead time, 5 - 10 business days in weekly route truck delivery zones.

*- 1 1/2" System -
1600 Series*

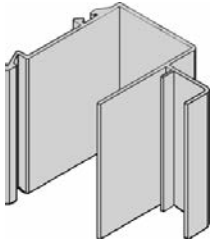

1600AV siderail

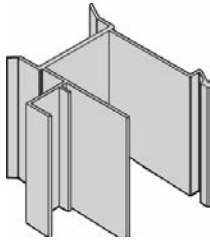

1600HV H-rail
- double couple for split doors -

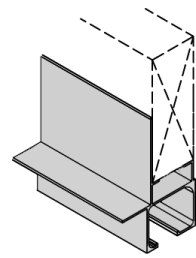

1600WB bottom rail

Available lengths: 8', 10', 12', 14' & 16'

Figure 1

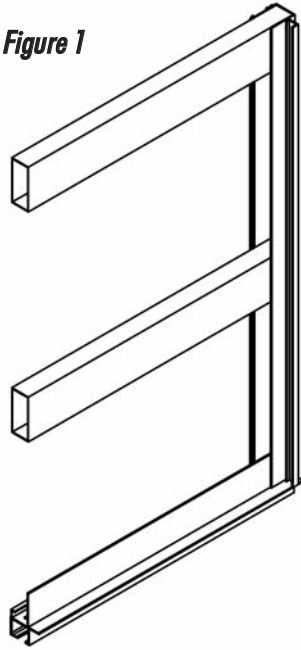

1600 series rail
w/ 1600WB bottom rail
shown with steel box girtd

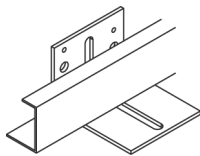

TRG bottom guide system
*- available in 5' & 10' sections -
used with 1600WB bottom rail*

ALL RAIL IS AVAILABLE IN STOCK WHITE OR CUSTOM COLOR OPTIONS
- consult powder coat chart for custom colors -

**- 1 1/2" System -
2200 Series**

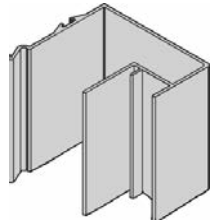

2200 siderail

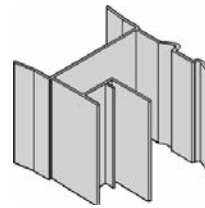

2216 H-rail
- double couple for split doors -

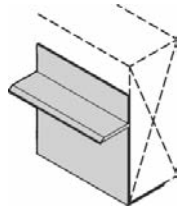

2201 bottom rail

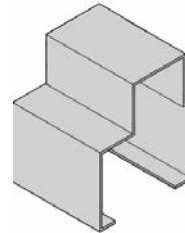

2244 bottom rail

Available lengths: 8', 10', 12', 14', 16', 18' & 20'

Figure 2

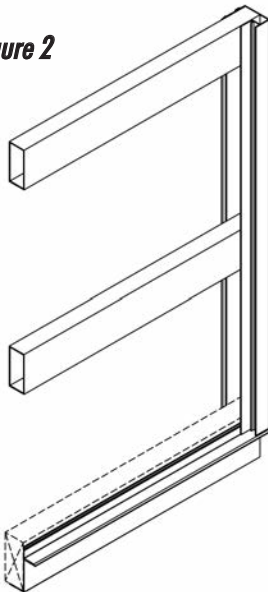

2200 series rail
w/ 2201 bottom rail
shown with steel box girt

Figure 3

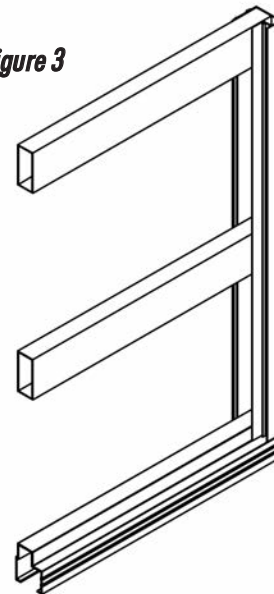

2200 series rail
w/ 2244 bottom rail
shown with steel box girt



BC92S stay roller
used with 2201 bottom rail

TBSG bottom guide system
*- available in 6', 8' & 10' sections -
used with 2244 bottom rail*

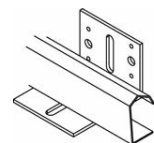

ALL RAIL IS AVAILABLE IN STOCK WHITE OR CUSTOM COLOR OPTIONS
- consult powder coat chart for custom colors -

*- 3 1/2" System -
3300 Series*

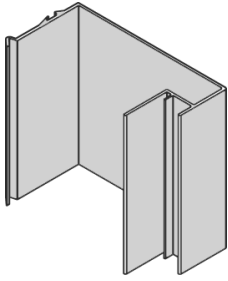

3391 siderail

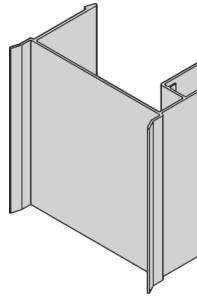

3396 H-rail
- double couple for split doors -

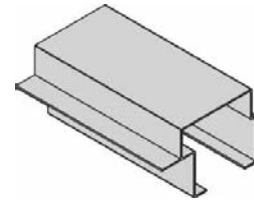

3394 bottom rail

Available lengths: 8', 10', 12', 14', 16', 18' & 20'

Figure 4

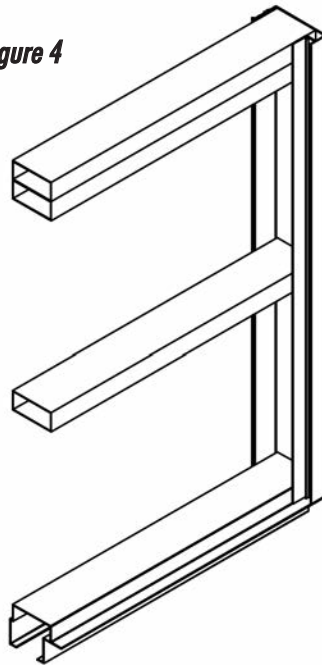

3300 series rail
w/ 3394 bottom rail
shown with steel box girt

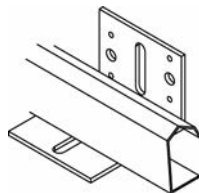

TBSG bottom guide system
*- available in 6', 8' & 10' sections -
used with 3394 bottom rail*

ALL RAIL IS AVAILABLE IN STOCK WHITE OR CUSTOM COLOR OPTIONS
- consult powder coat chart for custom colors -



SLIDING DOOR ASSEMBLY INSTRUCTIONS

NOTE: Fastener placement is up to the discretion of installer, a fastener groove is provided on backside of aluminum rail as an assembly guideline. Below is a process MWI has developed to help with installation.

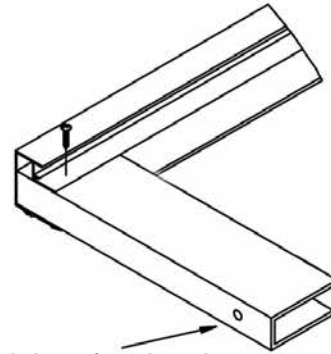

Drill 9/16" hole 12" from the end of the header for trolley hanger (24" for panels wider than 10')

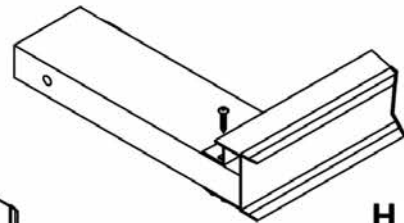

H RAIL

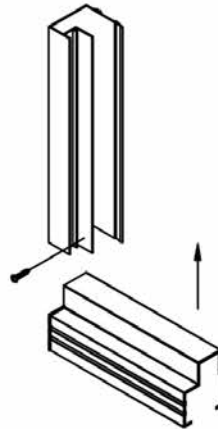

- 1 Insert the header into the aluminum side rail and fasten at top with (1) #10 x 1" self driller.
(other screws are added after door is square)

When using 3300 series rail, (2) MWI steel box girts are suggested in the header position to ensure proper stability.
(see figure 4)

- 2 Attach side rail or H rail to the other end of the header assembly and fasten with (1) #10 x 1" self driller. One H rail is recommended for snug fit on on split door applications as shown to the right

- 3 Insert the bottom rail into the side rail and fasten with (1) #10 x 1" self driller. 2244 bottom rail is shown to the right
(other screws are added after door is square)

Contractor may utilize a treated 2x6 in lieu of steel box girt with the 2201 bottom rail if desired *(see figure 2)*

- 4 Position box girts 24" O.C. apart, starting from the bottom of the door, checking for squareness. Fasten each girt with (1) #10 x 1" self driller per side. Make final check on door squareness and fasten (1) additional screw per box girt per side.

(each horizontal box girt should have 2 screws per side)

Installer may then choose to turn door over, recheck for squareness and repeat fastening procedure for added stability

DOOR HEIGHT	BOX GIRT QTY
8'	4
10'	5
12'	6
14'	7

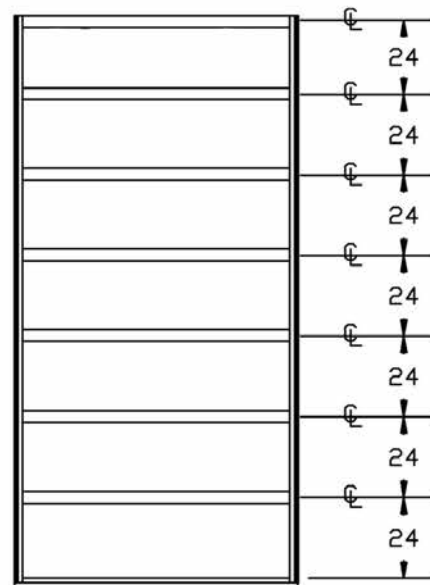

NOTE: Installer is responsible for verification that door weight is within hardware capacities *(see specifications in MWI track & hardware catalog)*